

# BRIDGEPORT LIBRARY

925 Broad Street ❖ Bridgeport, CT 06604 ❖ (203) 576-7400

Press Release – for immediate publication:

## Board of Directors

James E. O'Donnell  
President  
Sauda Efiya Baraka  
Vice President  
Thomas R. Errichetti  
Secretary / Treasurer  
Phylricia R. Brown  
Rosalina Roman Christy  
Anne Cunningham  
Donald W. Greenberg  
Hon. William Holden  
Kenya Osborne-Gant

## Directors Emeriti

John A. Arcudi\*  
Adele Jacobson\*  
Edward L. Kelley\*  
Helen Liskov  
John Phelan  
Hon. George A. Saden\*  
Zane Yost\*

(\* deceased)

Bridgeport Public Library acquires two additional sites for renovated East Side Branches: Bridgeport, CT - December 10, 2015

After acquiring the former Charles D. Smith Center at 755 Central Avenue last summer, The Board of Directors of the Bridgeport Public Library and Reading Room have now completed the purchase of two additional properties at which newly renovated branches, with state of the art computer tech centers, are being planned: on the lower East Side at 1174 East Main Street at the corner of Shelton Street, site of a former Salvation Army store, and on the upper East Side at 2534 East Main Street between Louisiana and Pennsylvania Avenues, where the former Hibachi Buffet and FitzWilly's Restaurant had been located. Acquisition of these sites satisfies goals of the Board's *Library Master Plan* to restore and improve facilities for essential Library services in strategic locations throughout Bridgeport and, along with the extended hours, improved collections and expanded programming already implemented, fulfills the promise of the Library Referendum to ensure that all residents of Bridgeport have free and open access to information and resources. A map showing the three locations and preliminary diagrams may be seen, along with the *Library Master Plan*, on the Library website: [www.bportlibrary.org](http://www.bportlibrary.org)

Judge William Holden, Chair of the Library Building Committee, and Board President, Jim O'Donnell, stated that Antinozzi Associates is preparing preliminary schematic drawings that the Library Board will review with members of each community to solicit input for preparation of the final construction drawings to renovate and improve each site. "Libraries have a core role to play in the economic development and revitalization of our neighborhoods" said City Librarian, Scott Hughes. The Library Board also will coordinate construction with Bridgeport's Small & Minority Business Resource Center, to ensure that the bid process attracts contractors who will employ Bridgeport residents. Jim O'Donnell noted that "It is important that these library branch tech centers, and the economic development they will foster, reflect the communities they serve. Every effort will be made to see that Bridgeport residents get the jobs these projects will require so they will enjoy the economic benefits of development, as well as the educational opportunities the completed library facilities will offer".

Each location has unique characteristics that will provide the basis for creating spaces that are open, bright, warm and inviting, where patrons will find a community home to pursue personal enrichment and gather to share information and experiences to knit together the strands of our wonderful, diverse City. The original Newfield structure, with its iconic fireplaces, high vaulted 18' ceiling and tall windows will be expanded with a new state of the art structure on an adjacent parcel to provide approximately 11,000 square feet of space. Library Board Member, Phylricia Brown, commented that: "Libraries are the gate to the future and as a resident of the East End I am so excited about the opportunities that the new Newfield Branch will bring to the neighborhood".

Press Release – Continued:

Bridgeport Public Library acquires two additional sites for renovated East Side Branches: Bridgeport, CT - December 10, 2015

The new branch will incorporate spaces for the library collection, computer tech center, innovation resources and community meeting rooms. Those amenities also will be found in the new East Main Street locations with the Hibachi/FitzWilly's site replacing the Old Mill Green Branch that will more than double the current space with the potential for future expansion using some of the extensive parking lot space available. Library Board Director, Rosalina Roman Christy, noted: "The constituents of the East End and East Side deserve to have a library in their neighborhood that meets the residents' needs. The Library Board has worked diligently to meet that need". The former Salvation Army location will require more extensive renovations, including installation of an elevator, to serve more than 14,000 square feet of space over three floors in the heart of the East Side, only a block from the former Jane Street Branch. Library Board Member, Anne Cunningham, stated: "These are very exciting times. For us, it's not just about building brick and mortar structures, but creating spaces of wonder where children can imagine a bright new future and begin to build it for themselves and their community".

Funding for the three projects has been established through bonding approved by the City Council that will be repaid from the Library Fund as budgeted by the Library Board so there will be no increase in taxes. The Library Board looks forward to working with Mayor Joe Ganim and the newly installed City Council to realize the opening of these facilities for the essential services the Library provides Bridgeport's residents as soon as construction will allow.

- For more information, contact:

Library Board President, Jim O'Donnell at (203) 767-6488.

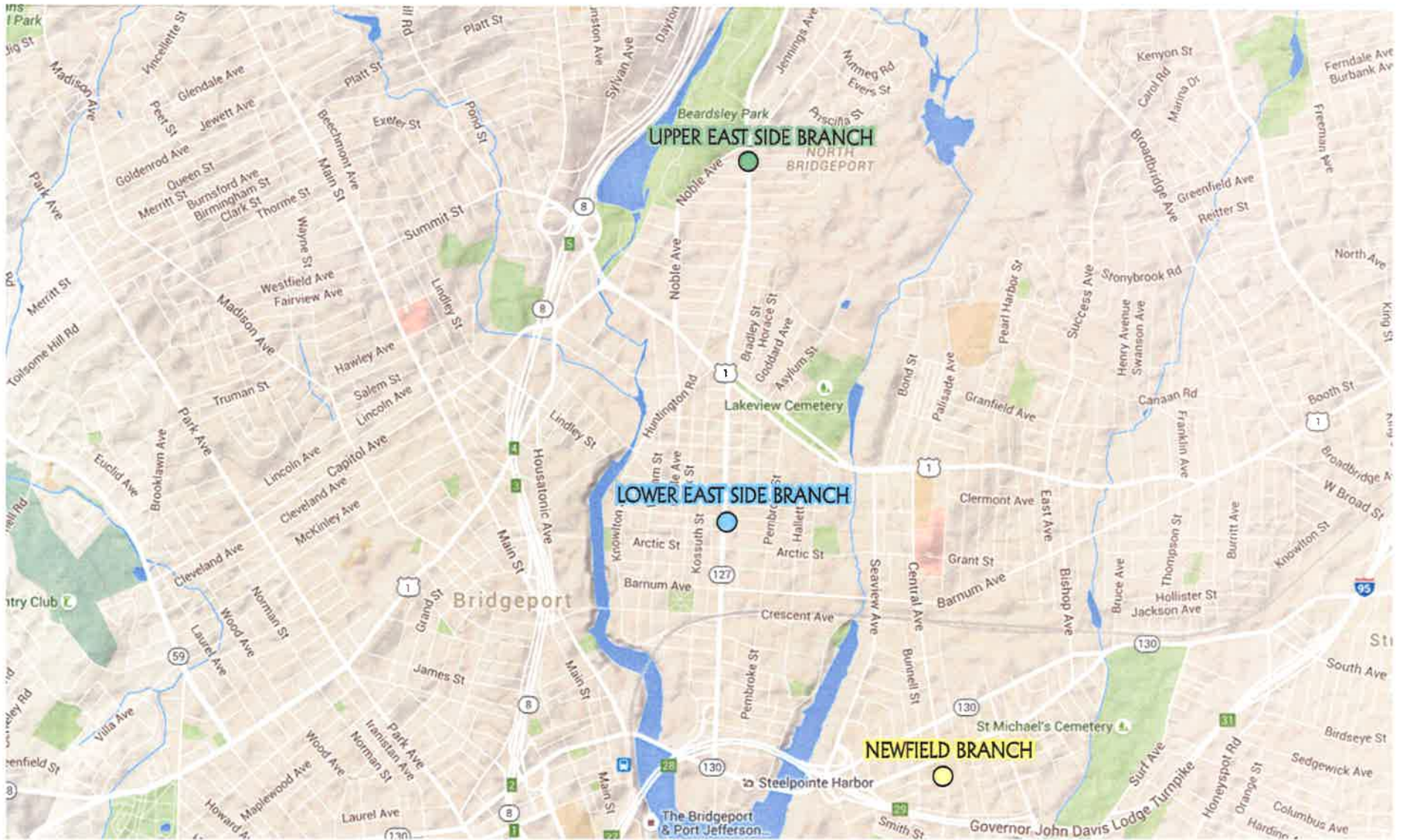

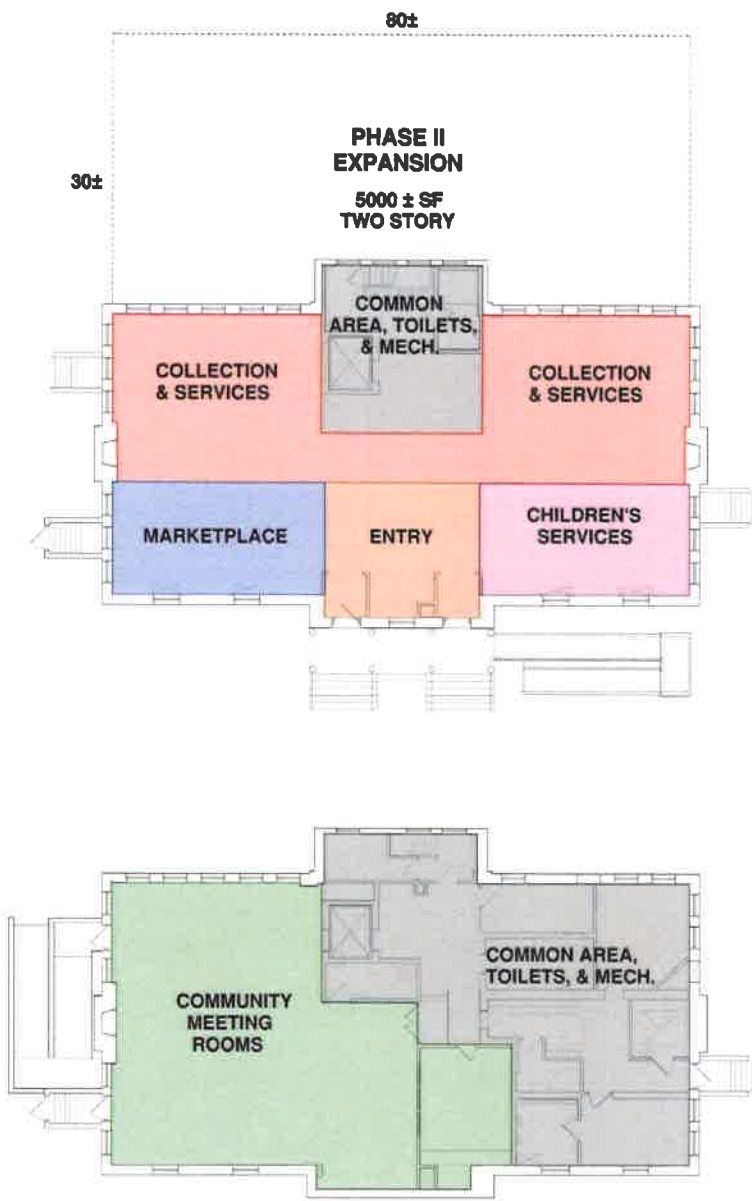

- ENTRY
- COMMUNITY MEETING ROOMS
- TECHNOLOGY MARKETPLACE
- COLLECTION & SERVICES
- CHILDREN'S SERVICES
- COMMON AREA, TOILETS, & MECH.



**EXISTING NEWFIELD BRANCH = 4,000 SF**  
**NEW ADDITION = 4800 SF**  
**NEW NEWFIELD BRANCH = 11,711 SF**





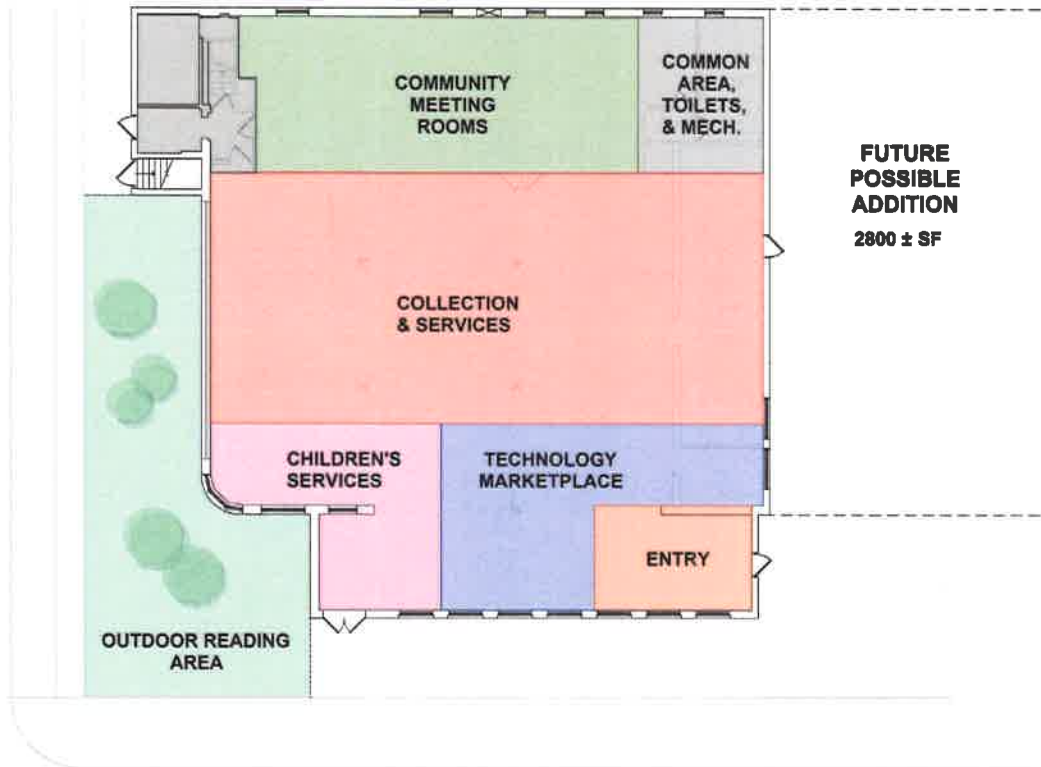

- ENTRY
- COMMUNITY MEETING ROOMS
- TECHNOLOGY MARKETPLACE
- COLLECTION & SERVICES
- CHILDREN'S SERVICES
- COMMON AREA, TOILETS, & MECH.



**EXISTING CONDITIONS**  
= 6,550 SF

**NEW ADDITION**  
= 2,800 SF

**NEW UPPER EAST SIDE BRANCH**  
= 9,350 SF

# LIBRARY PROGRAM IMAGES

ENTRY



CHILDREN'S SERVICES



COMMUNITY MEETING ROOMS



COMMON AREA, TOILETS, & MECH.



TECHNOLOGY MARKETPLACE



COMPUTER LAB



COLLECTION & SERVICES

